

MERAKI LED MODULES

FINGUERS CC SQUARE (145X249MM)

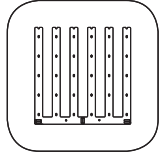

RECTANGULAR MERAKI CC MF are ideal to complete round or square designed light fixtures that require high efficiency and flexibility. These LED modules are capable to replace fluorescence downlights of 2x26W with no need to replace the whole fixture, meaning direct cost saving. At nominal power they do not need heatsinks. As a result of its easy installation and performance, is a perfect partner for professionals in light fixtures production. RECTANGULAR MERAKI CC MF modules are excellent items for development of light fixtures and cost saving (vs. former technologies). Constant voltage versions offer total flexibility.



In compliance with:

IEC 62031 / IEC 62471 / IEC 62717

APPLICATION

PRODUCT DESCRIPTION



- ZHAGA standard BOOK 7
- Luminous flux 900 lm
- High efficiency module >140lm/W
- Colour temperature 2700K/3000K/4000K/5000K
- Colour variation 2SDCM
- Operating temperature between -30°C and +40°C
- Luminous maintenance L70/B50 36.000 hours
- Flux and colour uniformity between modules
- Easy to install (with screws)
- Optional: double sided adhesive thermal tape
- Quick connectors (wires up to 1mm²)
- Reverse polarity protection
- 5 years guarantee



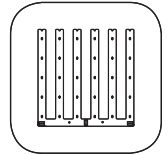

TECHNICAL DATA

- SELV voltage
- Available in 2700K-3000K-4000K-5000K
- Typical CRI80 (CRI90 available under request)
- Operating temperature between -30°C and + 45° C
- EN 61471:2008 group 1
- Standard Tc 65°C
- LED viewing angle 120°
- Weight 60 g
- MOQ 32 unit
- Possible to integrate with LOGO Custom

DIMENSIONS

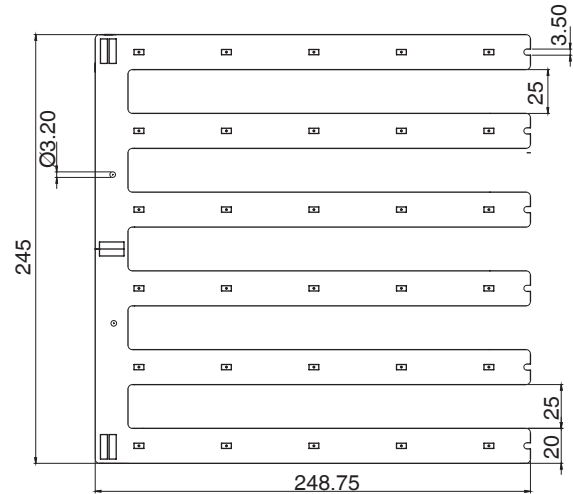

(*) Measured in mm

SPECIFIC TECHNICAL DATA

CODE	CCT	RATED CURRENT mA	SPECIFIC TECHNICAL DATA			NOMINAL POWER (W)	LUMINOUS EFFICACY (lm/W)	TOTAL FLUX (lm)	PHOTO METRIC CODE
			VOLTAGE Min (V)	VOLTAGE Typ(V)	VOLTAGE Max(V)				
WHITHOUT HEATSINK									
31.13.05102	2700K	350	33,6	35	36	1704	139,11	1704	827.348
31.13.05103	3000K	350	33,6	35,15	36	12,3	142,43	1752	830.348
31.13.05104	4000K	350	33,6	35,50	36	12,43	143,2	1780	840.348
31.13.05105	5000K	350	33,6	35,50	36	12,43	147,3	1831	850.348
WITH HEATSINK									
31.13.05102	2700K	500	33,6	35,90	36	17,95	121,9	2188	827.348
31.13.05103	3000K	500	33,6	35,40	36	17,7	125,48	2221	830.348
31.13.05104	4000K	500	33,6	35,90	36	17,95	128,01	2299	840.348
31.13.05105	5000K	500	33,6	35,50	36	17,75	134,18	2376	850.348

Note: Optical and electric measures with tolerance of +/- 10%.
For higher fluxes (500mA) is required to keep Tc < 65°C, with heatsink (not included).
QTY LED 48 CRI 82

MERAKI LED MODULES

FINGUERS CC SQUARE (145X249MM)

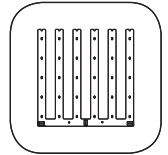

DRIVER + MODULE CONNECTION EXAMPLE

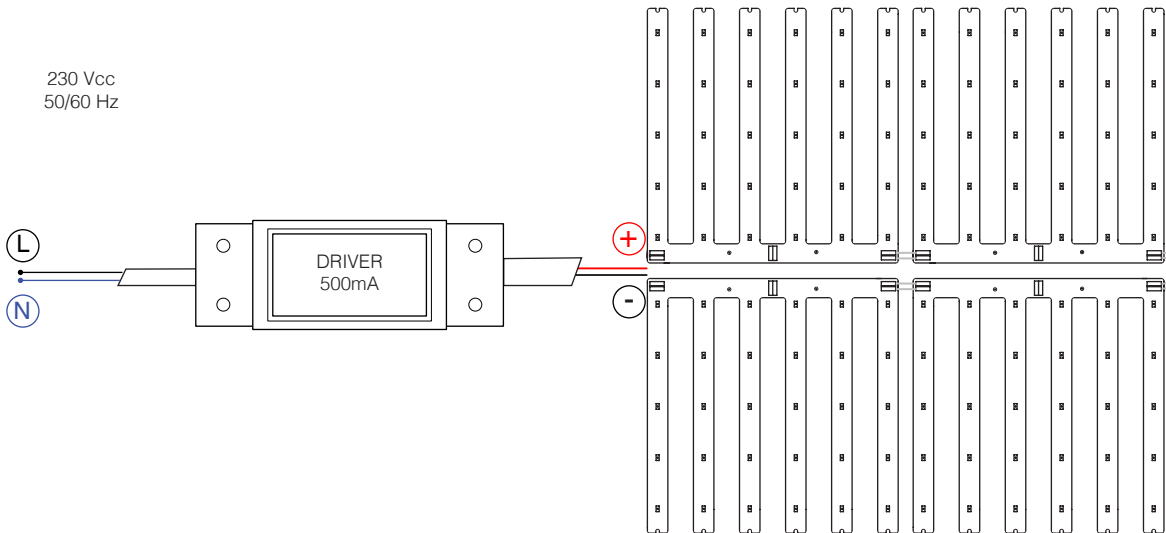

INSTALLATION AND CONNECTION EXAMPLE

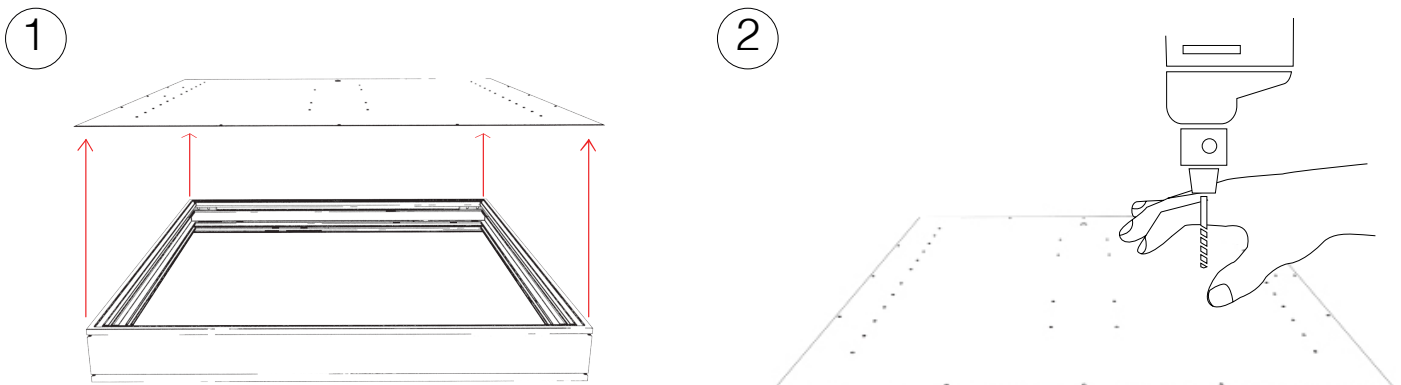

Dismantle profile base.

For eventual attachment of the fixture (with no use of double sided adhesive tape) drill a hole in the profile.



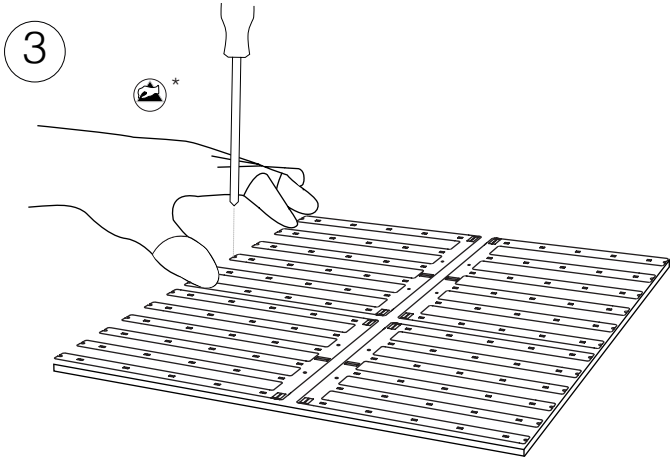
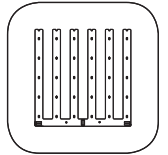

4

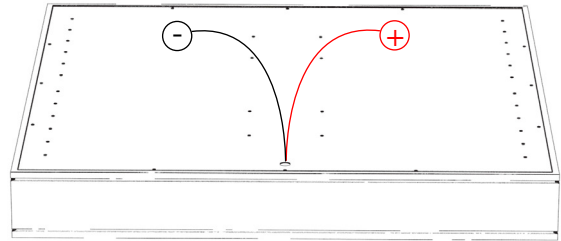

Place the PCB and apply pressure. Fix the screws to the fixture base. Note: Accessory M3 screws.

Introduce the positive (+, red) and negative (-, black) wires in the pre-made holes, and connect them to appropriate voltage.

(*) ESD protection

5

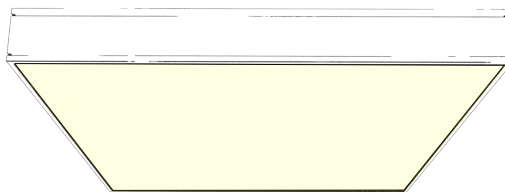

PCB is utterly installed.

Lifetime Derating for MERAKI CIRCULAR CC - MEDIUM FLUX

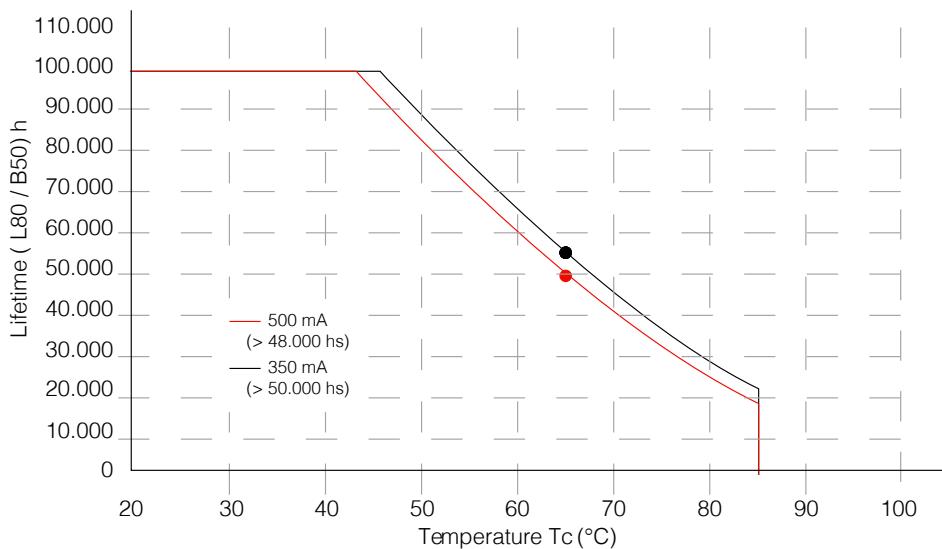

MERAKI LED MODULES

FINGUERS CC SQUARE (145X249MM)

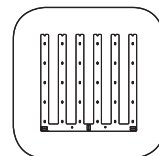

INFORMACIÓN DE SEGURIDAD E INSTALACIÓN



ELECTRICAL POWER

RECTANGULAR MERAKI FINGERS must be feed at constant current; the energy source power must be in accordance with the quantity of connected modules for proper functioning of the module (or group of modules). Family merakihave polarity, for this reason rated current, nominal power and polarity must be taken into account. If that is not the case, the module might be irreversibly damaged. MERAKI LED MODULES require specific driver protection against short-circuit currents, temperature raise and overloads.



ISOLATION

RECTANGULAR MERAKI FINGERS functions with SELV voltage, does not require active isolation of the component as long as maximum reference (50v) SELV voltage is not exceeded. In other case, it will be mandatory earth connection on all conductive components of the fixture or light engine when the number of modules in the series exceeds SELV voltage. The driver must be in compliance with CE, UL or valid analogous regulation.



ESD – STATIC ELECTRICITY INFORMATION

RECTANGULAR MERAKI FINGERS contains electronic components which are very sensible to static electricity. In this respect is it highly recommendable to always manipulate the items with appropriate ESD protection, and take adequate measures for safety matters. If you need further information please refer to our webpage www.idled.eu.



MOUNTING AND INSTALLATION

I+D LED S.L. is not responsible for the installation of the product. RECTANGULAR MERAKI FINGERS must be perfectly placed (and/or stick) on the lighting device, profile or base for a proper connection between modules and power source, respecting its nominal values. I+D LED S.L. is not responsible for occasional module fall. If any type of chemical substance is used during the assembly of the luminaire or light engine, it must not have any type of curing by means of gas condensation; as these chemical substances may damage the LEDs and electronic components. The module will be delivered with 8 pre-made holes; like drawing. Maximum torque for fixing recommended 0,4-0,5 Nm to avoid mechanical stress. Ideal wire for this connection type is unipolar rigid wire of 0,4-1mm², with a strip wire of 6,5-7MM. To remove wire, push orifice on the connector and pull smoothly.



TEMPERATURE

RECTANGULAR MERAKI FINGERS life-time depends to a great extent on operating temperature. Under no circumstance temperature should exceed the maximum permissible (Tc=85°C) limit here indicated. Exposure to higher temperatures might affect its long term proper functioning. Room temperature must be measured under worstcase conditions to ensure life-time and keep product's guarantee. Store modules between -20 °C and +80 °C, and at a maximum humidity level of 65%.



OPTICAL CHARACTERISTICS + CCT

Measurement of LED discrete points may have variations in regards on the CCT temperature here described, with a variance of 3SDCM for white and +/- 5nm for coloured LEDs. CCT shifts +/- 0,001 at 6.000 hrs. 3 SDCM are declared over the complete module. Modules viewing angle is 120°.

